

VOLCANO MAKING KIT

WARNING:
CHOKING HAZARD – Small parts.
Not for Children under 3 years.



PAINTING TIPS

You can use your own colour scheme or copy the illustration on the package. For best results apply more than one layer of paint, but wait until the first layer is dry before applying a second coat. It is always easier to paint a darker colour on a lighter colour background than the other way round. You can also mix a small drop of dishwashing detergent with the paint, which will help the paint stick to the surface better (especially with plastic surfaces). Follow the colour mixing guide below to produce more colours. (Some of the following suggestions may not apply to your kit if the required colours are not included.)

To make green mix yellow and blue
To make orange mix yellow and red
To make purple mix blue and red
To make pink mix red and white

To make sky blue mix blue and white
To make lime green mix yellow and a little blue
To make brown mix red and yellow and a little black
To make turquoise mix blue and white and a little yellow

Mix the colours with white and black to make them lighter or darker. Do not mix too many colours together because that will make the final colour muddy. Always wash your paint brush in a jar of clean water before mixing or applying a new colour. It is also a good idea to use a mixing tray for mixing paints. Close the pot lids tightly to prevent the paints drying up. If the paint is dry, dilute it with a few drops of water.

RECYCLING TIPS

To help save our planet, do not throw away any unused materials. Keep them for future projects. You can use spare paint brushes and paint for craft projects at home and school. Buy more plaster powder from your local craft store. The plastic mould can be used to make as many volcanoes as you like. Use a small plastic bottle as the eruption chamber. If it is too tall for your volcano, ask an adult to cut the middle part away. Then connect both ends with adhesive tape to make a short bottle that can be buried completely by the plaster.

QUESTIONS AND COMMENTS

We want you to be happy with this product. If you have any comments or questions or you find parts of this kit missing or defective, please contact our distributors in your country, whose address is printed on the package. You can also contact our marketing support team at infodesk@4M-IND.com, Fax (852) 35898200, Tel (852) 35898201-3 or visit our website at www.4M-IND.com

41-02601/15 090626

© 2004 4M INDUSTRIAL DEVELOPMENT LIMITED.

A. SAFETY MESSAGES

1. Please read through these instructions before you start.
2. Adults assistance and supervision is required.
3. Intended for children of ages over 8.
4. This kit and its finished product contain small parts which may cause choking if misused. Keep away from children under 3 years old.
5. Plaster dust may irritate the eyes, nose and throat. Do not place the material in the mouth or apply it to body. Avoid contact with the eyes and inhalation of dust. In case of eyes contact, flush with water and consult your physician if discomfort persists.

B. IMPORTANT INSTRUCTIONS

1. Always work on a solid, level surface and try to keep the area neat and clean. Do not pour the powder down the sink or bath plug hole as it may block the drain. Wash any utensils under running water.
2. Put on an apron or wear old clothes. If clothes are stained by paint then wash immediately. Dried paint may leave stains on clothes even when they are washed.

C. CONTENTS

One volcano mould, two bags of fine-quality plaster mix, one paint strip of six colours, a brush, a stirrer, a sheet of fun graphics for decoration, a set of instructions including volcano science fun facts and how to make your volcano erupt.

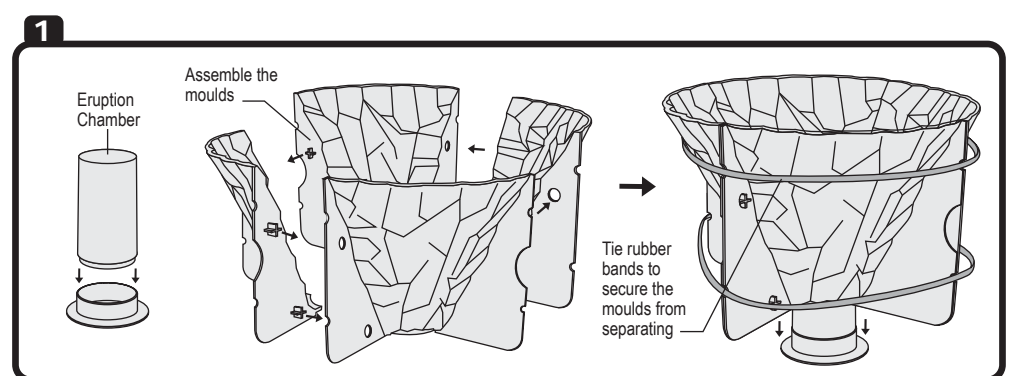

D. INSTRUCTIONS

1. CONSTRUCTING YOUR VOLCANO MOULD

Before you start, make sure your working surface is flat. Cover it with aluminium foil or old newspaper. Follow the diagrams to assemble the moulds.

2. MIXING AND MOULDING

You will need: a mixing bowl, scissors to open the bags of plaster and a spoon to stir the plaster mixture.

1. Cut open the two bags of plaster mix using the scissors and pour into the mixing bowl.
2. Add approximately 280ml water to the plaster powder and stir the mixture until it becomes a smooth paste.
3. Pour this paste into the mould and gently shake the mould to get rid of any air bubbles.
4. Leave the plaster to set. This will take about 20–30 minutes at room temperature. It's normal for the plaster mixture to warm up as it hardens.
5. Once the plaster has fully hardened, gently remove it from the mould. The chamber will stay with the plaster.

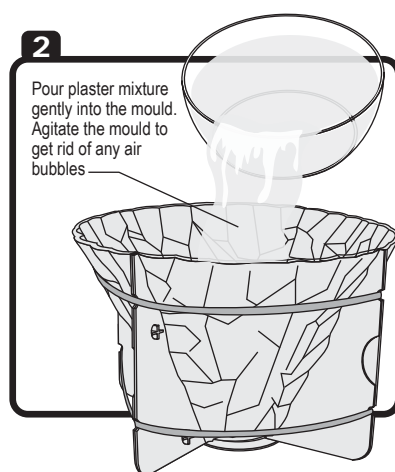

3. PAINTING AND DECORATING YOUR VOLCANO

For the best results, allow the plaster to dry completely before applying any paint. This can take up to 24 hours. Paint the volcano a brown/red colour or choose your own colour scheme using the paints and brush provided. Read the paint mixing tips to create many more colours to decorate your volcano and look at the cover of the box for ideas.

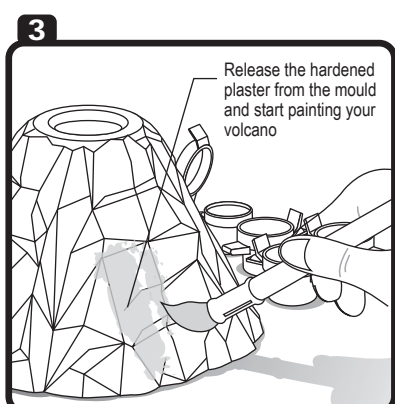

4. MAKEING YOUR VOLCANO ERUPT

You will need some vinegar and baking soda to make your volcano erupt. As it erupts, bubbly, fizzy liquid will flow from the volcano. It's best to place the volcano outdoors or on a protected surface to avoid any mess or staining.

1. Put a teaspoonful of baking soda into the eruption chamber and add a few drops of washing up liquid and red paint so it looks like lava.
2. Slowly pour a teaspoonful of vinegar into the eruption chamber and watch the eruption happen.
3. You can continue adding vinegar until the baking soda has been fully dissolved. When it is finished, you will need to ask an adult to get you some more.

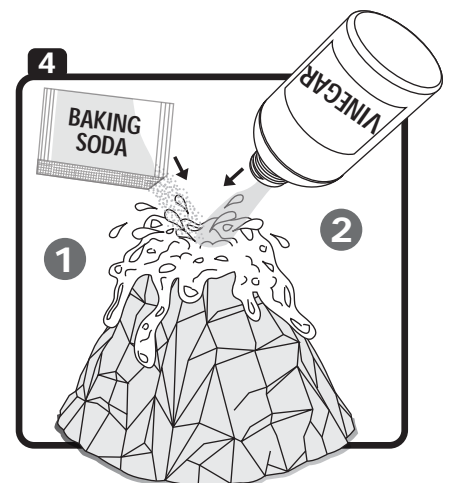

E. FUN FACTS

Deep inside the Earth, at temperatures reaching over 1,000 degrees Celsius, rock melts to form magma. This rises to the Earth's surface and erupts to form the lava flows that make up volcanoes.

Hawaii's Mauna Loa is the largest volcano on Earth. Its height is about 10 kilometres from the sea floor, and its volume is about 80,000 cubic kilometres.

The largest volcano in our solar system is the Olympus Mons on Mars. It is about 27 kilometres tall and over 520 kilometres across.

While volcanic eruptions can be destructive, they benefit the Earth by adding minerals and nutrients to the soil. Lava flows from volcanoes help to create and shape our landscape when they harden. Can you imagine how the world would be without volcanoes?